

FRONT SIDE MEMBER (ASSY) REPLACEMENT

1. REMOVE RADIATOR UPPER SUPPORT (See page BP-1)
2. REMOVE RADIATOR SUPPORT UPPER BRACE (See page BP-3)
3. REMOVE FRONT CROSSMEMBER SIDE REINFORCEMENT (See page BP-20)
4. REMOVE COWL TOP SIDE PANEL (See page BP-18)
5. REMOVE FRONT FENDER APRON (See page BP-12)
6. REMOVE FRONT SIDE MEMBER

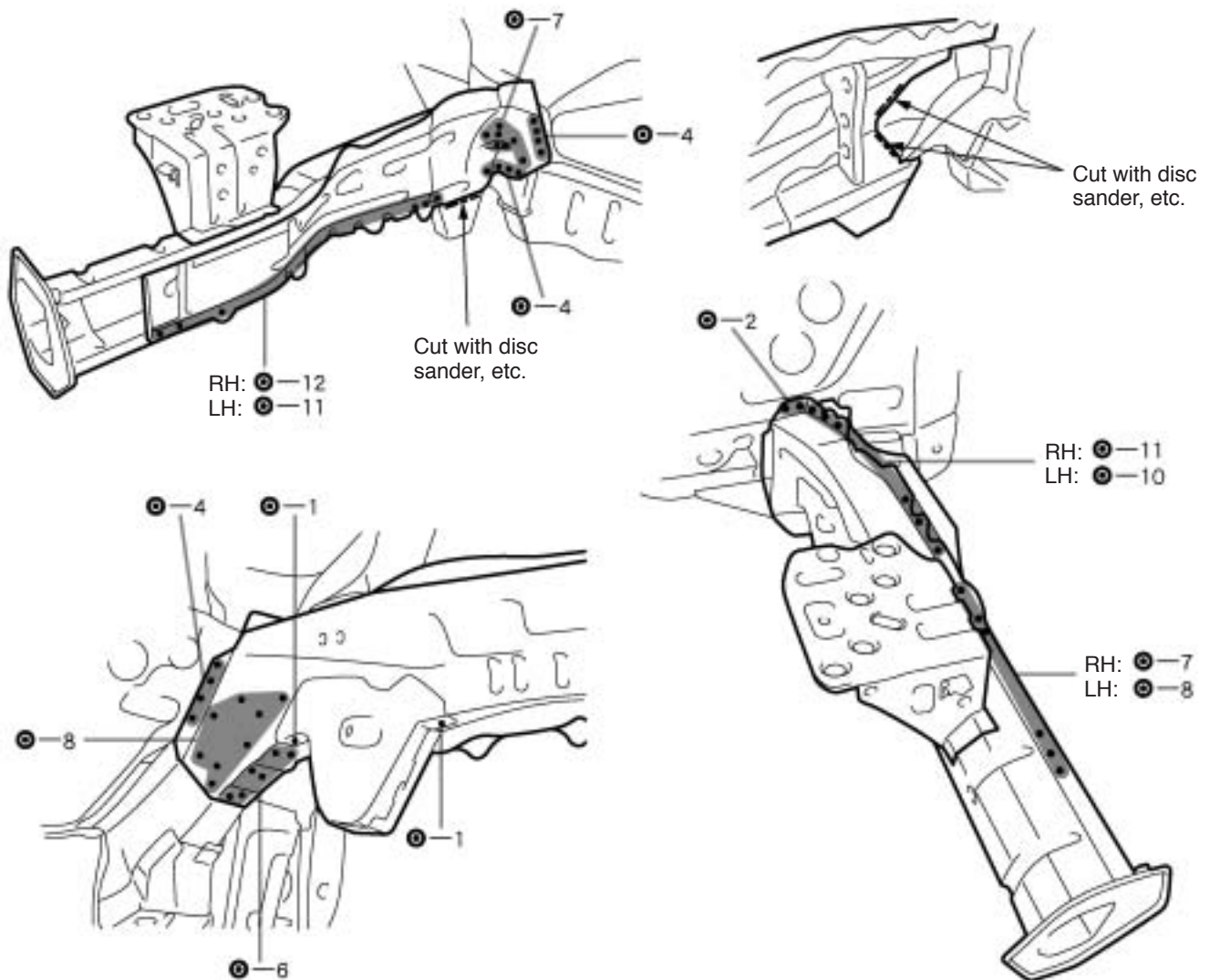

7. INSTALL FRONT SIDE MEMBER

- (a) Temporarily install the new parts and measure each part in accordance with the body dimension diagram.

HINT:

Make sure each measurement is correct, as this parts affects the front wheel alignment.

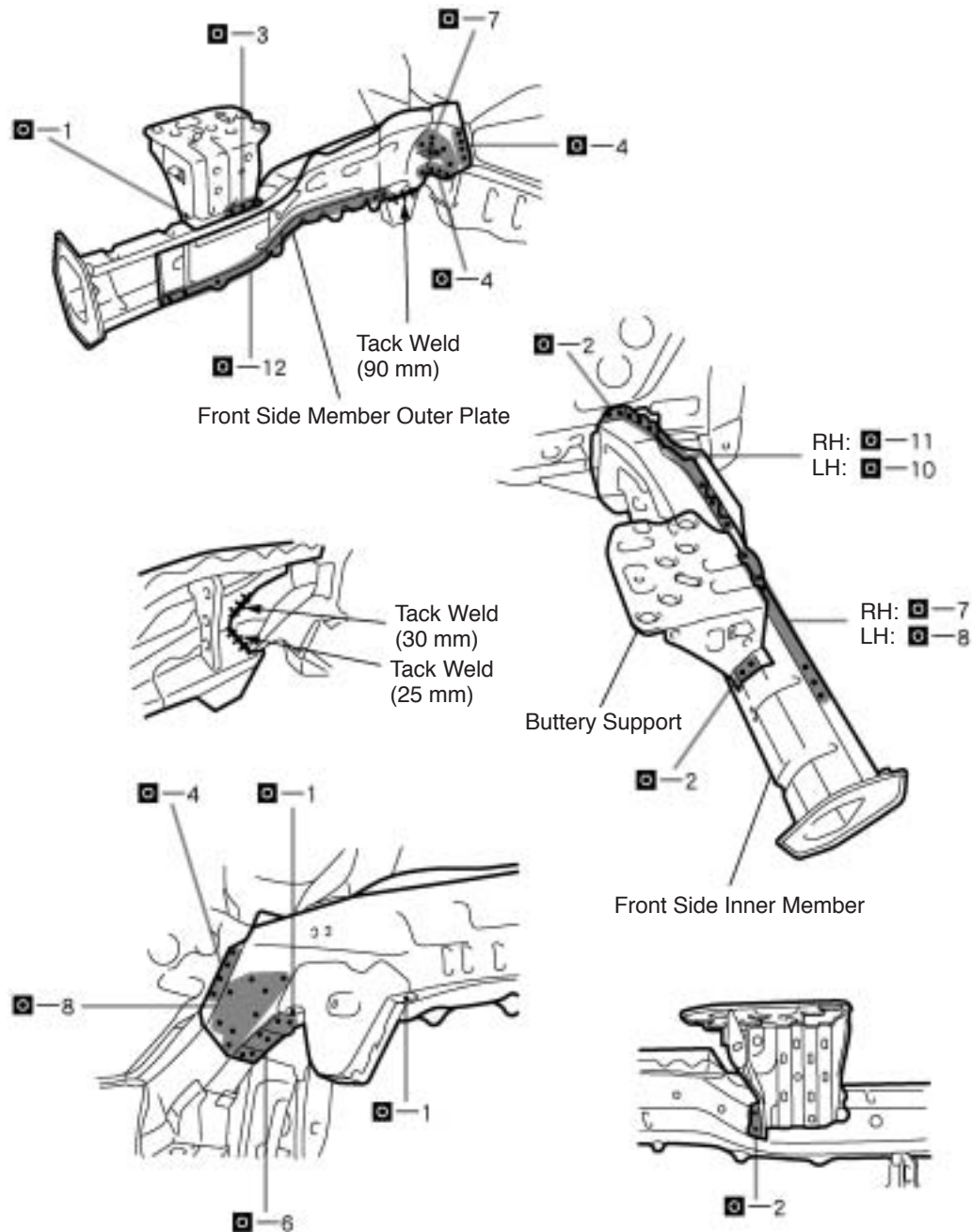

mm	in.
25	0.98
30	1.18
90	3.54

-
8. MEASURING THE ENGINE COMPARTMENT DIMENSIONS ([See page BP-94](#))
 9. MEASURING THE UNDER BODY DIMENSIONS ([See page BP-94](#))
 10. INSTALL FRONT FENDER APRON ([See page BP-15](#))
 11. INSTALL COWL TOP SIDE PANEL ([See page BP-18](#))
 12. INSTALL FRONT CROSSMEMBER SIDE REINFORCEMENT ([See page BP-20](#))
 13. INSTALL RADIATOR SUPPORT UPPER BRACE ([See page BP-3](#))
 14. INSTALL RADIATOR UPPER SUPPORT ([See page BP-1](#))
 15. APPLYING SEALER TO THE ENGINE COMPARTMENT ([See page PC-1](#))
 16. APPLYING UNDER COATING ([See page PC-6](#))
 17. APPLYING ANTI-RUST AGENT
 - (a) After applying the top coat layer, apply the anti-rust agent to the inside of the necked section structural weld spots.